

Transmission

Material

Item	Specification
MERCON® V Automatic Transmission Fluid XT-5-QM (or XT-5-QMC) (US); CXT-5-LM12 (Canada)	MERCON® V
Premium Long-Life Grease XG-1-C or XG-1-K (US); CXG-1-C (Canada)	ESA-M1C75-B

Installation

1. **NOTE:** Before installing the transmission, the input shaft must be cleaned and lubricated with a small amount of grease.

Position the transmission to the transmission jack at a 30 degree counterclockwise angle and securely strap the transmission to the transmission jack.

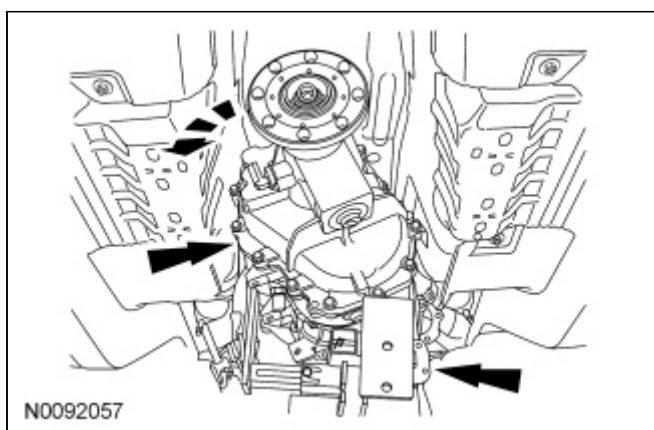

2. Position the transmission to the engine. Rotate the transmission clockwise and align the dowels.
3. **NOTE:** Insert the clutch hydraulic tube into the clutch slave cylinder and install the clip before tightening the transmission-to-engine bolts.

Install the 7 transmission-to-engine bolts.

- Tighten to 45 Nm (33 lb-ft).
4. Install the 2 spacer plate bolts.
 - Tighten to 35 Nm (26 lb-ft).
 5. Attach the wire harness retainer clip to the transmission.

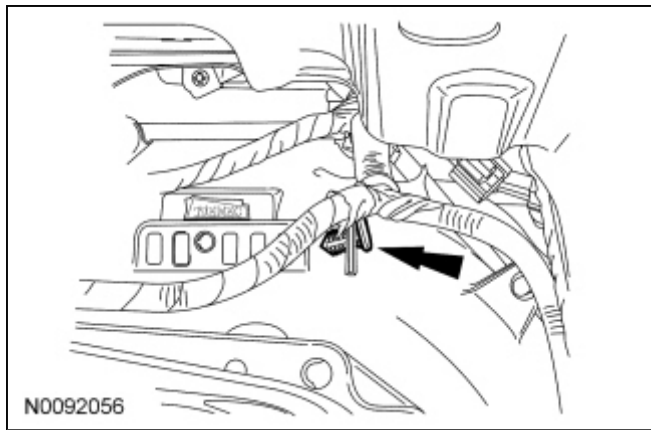

6. Connect the shift linkage to the transmission and install the gearshift lever assembly bolts.
 1. Tighten to 40 Nm (30 lb-ft).
 2. Tighten to 15 Nm (133 lb-in).

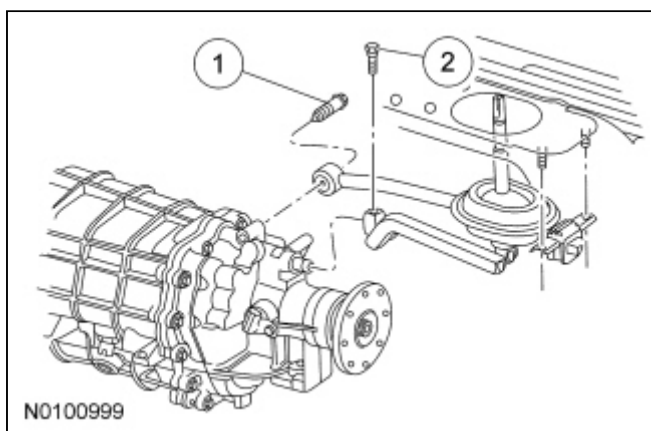

7. Install the 2 rear gearshift lever nuts.
 - Tighten to 11 Nm (97 lb-in).

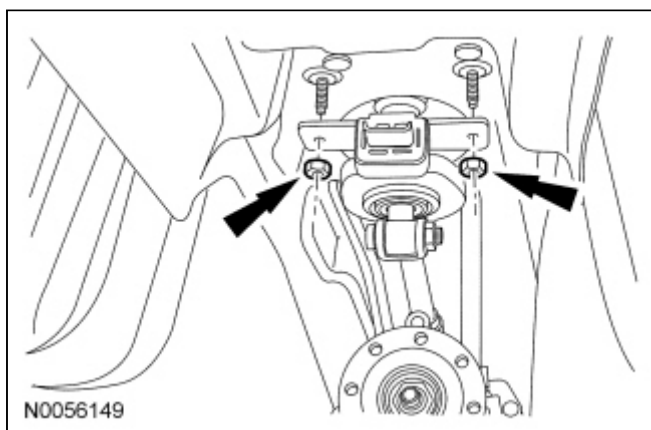

8. **NOTE:** The hump side of the crossmember goes up.

Install the transmission crossmember. For additional information, refer to [Section 502-00](#).

9. Connect the Output Shaft Speed (OSS) sensor electrical connector and attach the wiring harness to the transmission.

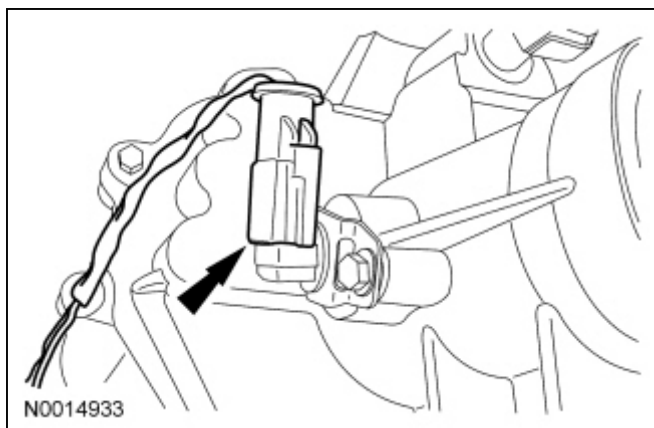

10. Install the catalytic converter H-pipe. For additional information, refer to [Section 309-00](#).
11. Connect the reverse lamp switch electrical connector and attach the wiring harness to the transmission.

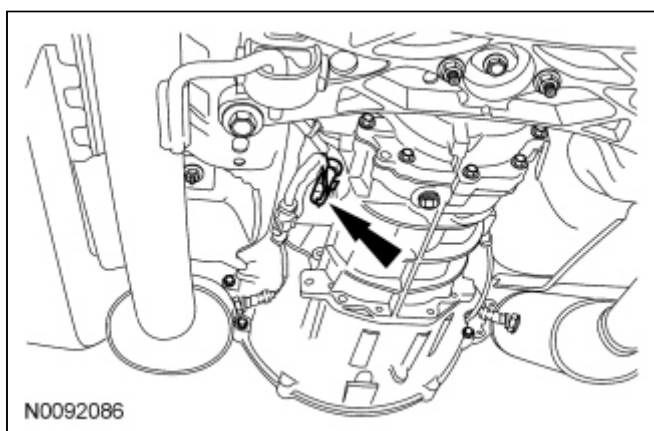

12. Install the subframe cross brace and the 4 subframe cross brace nuts.
 - Tighten to 48 Nm (35 lb-ft).

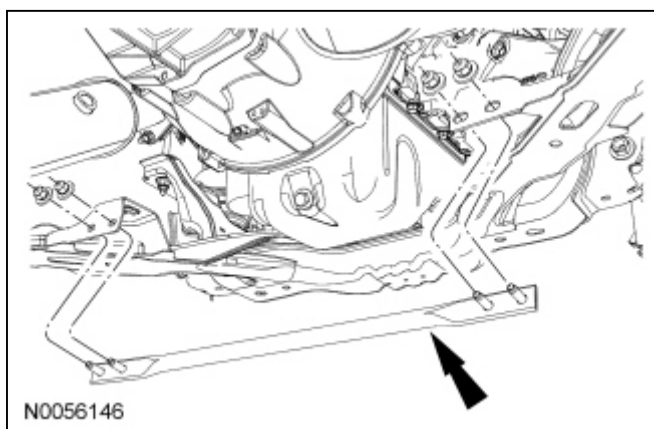

13. Install the starter and the 3 starter motor bolts.
 - Tighten to 25 Nm (18 lb-ft).

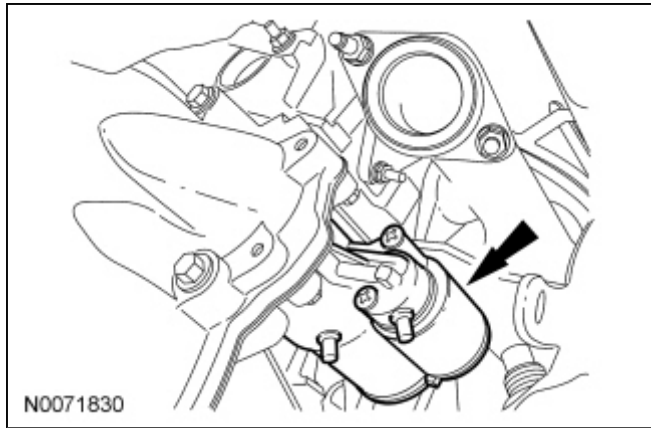

14. Install the driveshaft. For additional information, refer to [Section 205-01](#).
15. Fill the transmission with transmission fluid as necessary. For additional information, refer to [Transmission Draining and Filling](#) in this section.
16. Install the gearshift lever boot and knob.
 - Turn the gearshift lever knob in a clockwise direction.

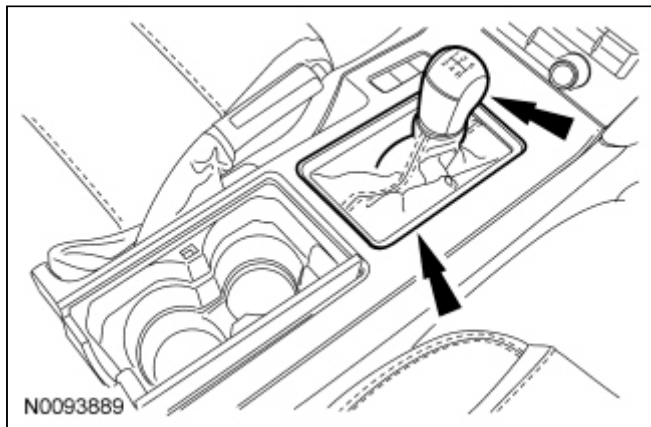

17. Connect the battery ground cable. For additional information, refer to [Section 414-01](#).
 18. Fill the brake and clutch reservoir. Bleed the clutch hydraulic system. For additional information, refer to [Section 308-00](#).
-

